

ZY1020



Application:

Electric Vehicle

Electric Oil Pump

Electric Tool

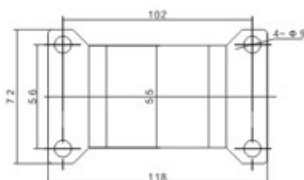
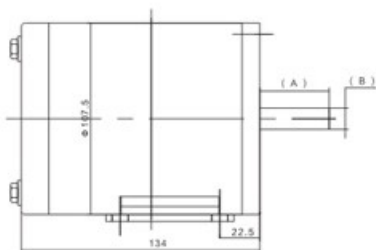
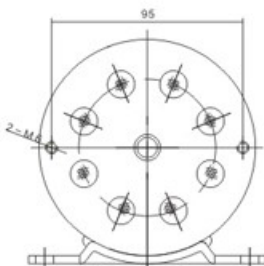

SPECIFICATIONS

规格型号	空 载		负 载				备 注
	电流 (A)	转速/rpm	扭矩/N.m	转速/rpm	功率/W	电流 (A)	
350W24V	2.0	2750	1.49	2250	350	18.7	
350W36V	2.0	2750	1.49	2250	350	12.5	
500W24V	2.5	3000	1.91	2500	500	26.7	
500W36V	2.0	3000	1.91	2500	500	17.8	
750W36V	2.5	3350	2.56	2800	750	26.7	
750W48V	2.0	3350	2.56	2800	750	20.0	
800W36V	2.5	3500	2.78	2750	800	28.5	
800W48V	2.0	3500	2.78	2750	800	21.4	